

Leased

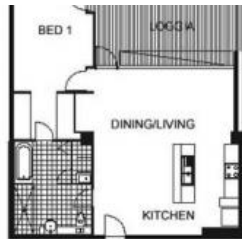

5, 10 Pyrmont Bridge Road, Camperdown



Etage Apartments
Type G2
Apartments:
G 05
G 18
1 05
1 16



NORTH FACING ONE BEDROOM APARTMENT!

Stunning one bedroom apartment perfectly located in "Etage". North facing aspect offering loads of natural light and a superb flow of indoor/outdoor living to accentuate this sought after inner city lifestyle.

- Ultra modern kitchen with dishwasher
- Spacious combined lounge/dining flowing to loggia
- Sleek dual access bathroom, internal laundry
- Generous bedroom with built-in wardrobes
- Security building with security car space

Being in The City Quarter Complex you will be able to enjoy the free, unlimited access to your choice of a 50m outdoor or 25m indoor pool and two gyms. The complex also has 24 hour security, a Japanese restaurant, cafe & convenience store. Only a 10 min bus ride to the city or an easy stroll to Glebe, Broadway, Leichhardt and Newtown.

The above information provided has been furnished to us by the vendor/s. We have not verified whether or not that information is accurate and do not have any belief in one way or the other in its accuracy. We do not accept any responsibility to any person for its accuracy and do no more than pass it on. All interested parties should make and rely upon their own inquiries in order to determine whether or not this information is in fact accurate.

🛏 1 📶 1 🚗 1

Price \$610 p/w
Property Type Rental
Property ID 800

Agent Details

William Chen - 0430 026 436
william@greenciff.com.au

Office Details

Greenciff Sydney Kent St
Level 10/488 Kent Street Sydney NSW
2000 Australia
02 8823 8818

greenciff
Inner city specialists