

Leased

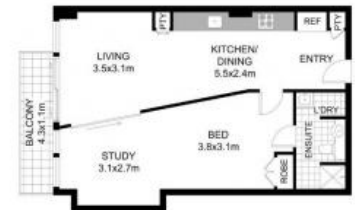

10 Pyrmont Bridge Rd, Camperdown



greenciff
Inner city specialists

STYLISH ONE BEDROOM APARTMENT IN THE CITY QUARTER COMPLEX

Bright and airy one bedroom apartment situated in the popular "Etage" building within the sought after City Quarter complex.

Features include:

- Galley style kitchen with gas cook top, dishwasher and pull-out pantry
- Combined open plan living area with near new carpet, light and airy throughout
- Ensuite bathroom and internal laundry including clothes dryer
- Separate extra large bedroom with built -in wardrobes
- Moments from shops, cafes, transport, Sydney University and RPAH

Being in The City Quarter Complex you will be able to enjoy the free, unlimited access to your choice of a 50 metre outdoor or 25m indoor pool and two gymnasiums. The complex also has 24 hour security, a Japanese restaurant & cafes.

Only a 10 minute bus ride to the city or an easy stroll to Tramsheds, Jubilee park, Glebe, RPA hospital, Sydney University, Broadway, Leichhardt and Newtown which are just around the corner.

For further information or to inspect, please contact Tammy on 0431 511 907 or email: tammy@greenciff.com.au

The above information provided has been furnished to us by the vendor/s. We have not verified whether or not that information is accurate and do not have any belief in one way or the other in its accuracy. We do not accept any responsibility to any person for its accuracy and do no more than pass it on. All interested parties should make and rely upon their own inquiries in order to determine whether or not this information is in fact accurate.

1 1

Price

LEVEL 2 | LEASED AT FIRST INSPECTION

Property Type

Rental

Property ID

6195

Agent Details

Tammy (Rungnapa) Kanittanon - 0431 511 907
tammy@greenciff.com.au

Office Details

Greenciff Camperdown Office
Shop 1 1 Sterling Cct Camperdown NSW
2050 Australia
02 8262 8262

greenciff
Inner city specialists