

Leased

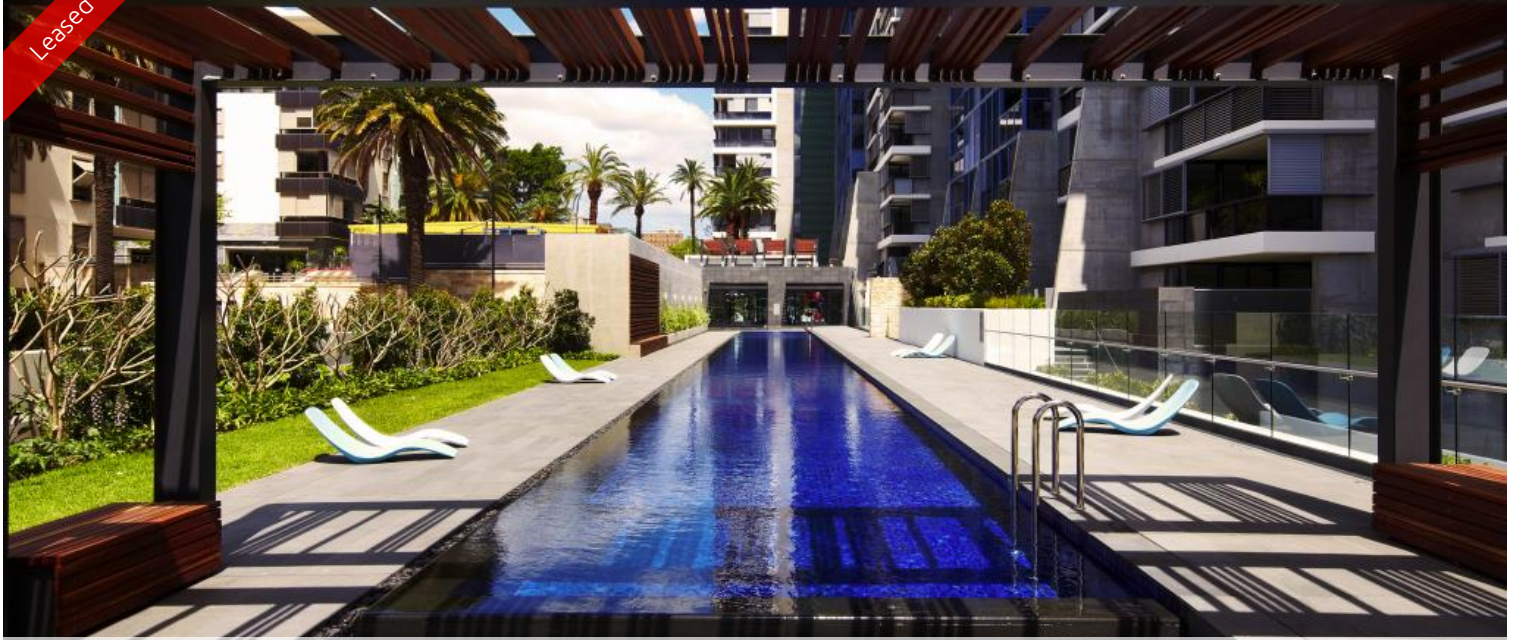

1 Sterling Cct, Camperdown



INSPECTION CANCELLED

Occupying an elevated site on the corner of Booth Street and Pyrmont Bridge Road, Camperdown, Trio is a bold and brilliant addition to the landscape.

Trio is just a 10 minutes bus ride to Sydney CBD, with major universities, RPA Hospital, Broadway Shopping Centre, Annandale shopping village and transport all within walking distance.

Apartment features: -

- Spacious living area boasting tranquil leafy outlook
- Ultra modern open plan kitchen with gas cook top and dishwasher
- Private loggia with timber deck, ideal for alfresco entertaining
- Large bedroom with built-in wardrobe, light and airy throughout
- Internal laundry
- Bathroom with separate bath and shower
- Undercover security car space
- Ducted air conditioning

Enjoy unlimited access to your choice of a 50 metre outdoor or 25m indoor pool and two gymnasiums. The complex also has 24 hour security, a Japanese restaurant, cafes & convenience store.

For more information, please contact Nicole Guibani on 0435 127 552

**Please note, images used maybe indicatives only.

The above information provided has been furnished to us by the vendor/s. We have not verified whether or not that information is accurate and do not have any belief in one way or the other in its accuracy. We do not accept any responsibility to any person for its accuracy and do no more than pass it on. All interested parties should make and rely upon their own inquiries in order to determine whether or not this information is in fact accurate.

 1  1  1

Price

L3/1 Sterling Circuit |
DEPOSIT TAKEN

Property Type

Rental

Property ID

3911

Agent Details

Michelle Kilala - 0419 777 239
michelle@greenciff.com.au

Office Details

Greencliff Camperdown Office
Shop 1 1 Sterling Cct Camperdown NSW
2050 Australia
02 8262 8262

greenciff
Inner city specialists